

BD SafetyGlide™ Needle

Instructions For Use

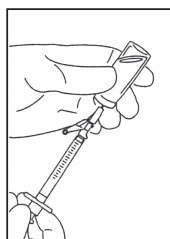

Figure 1

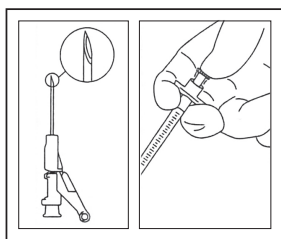

Figure 2

• Bevel Up = Lever Arm Up

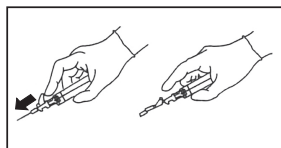

Figure 3

• Activated After Use

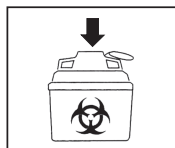

Figure 4

Push firmly when attaching the needle to the syringe.

Draw up medication in accordance with established protocol. (refer to Figure 1)

Administer medication in accordance with established protocols. For user convenience, the needle “bevel up” position is oriented to the lever arm as shown. (refer to Figure 2)

Activate Safety Mechanism immediately after removal from patient by pushing lever arm completely forward until needle tip is completely covered. Visually confirm that the lever arm has fully advanced and the needle tip is covered. If unable to activate, discard immediately into an approved sharps collector. (refer to Figure 3)

Discard after single use in an approved sharps collector in accordance with applicable regulations and institutional policy. (refer to Figure 4)

Use one handed technique and activate away from self and others.

Activation of the protective mechanism may cause minimal splatter of any fluid that is remaining on the needle after injection.

Non-pyrogenic. Do not use if individual packaging is damaged.

CAUTION:

Where local and/or institutional procedures permit/require transportation of the filled syringe, use a passive recapping technique to cover the needle before transporting to the point of administration. USA only: OSHA standards require that such recapping must be accomplished using a one handed technique. DO NOT hold the needle shield during the recapping process.

To help avoid HIV (AIDS), HBV (Hepatitis) and other infectious diseases due to accidental needlesticks, activate the protective mechanism immediately after use.

Federal (USA) law restricts this device to sale by or on the order of a physician.

Do not autoclave BD SafetyGlide™ Needle before use.

Caution: Re-use may lead to infection or other illness/injury.

K-01552-112B (5/15)

BD SafetyGlide™ Needle

Instructions For Use

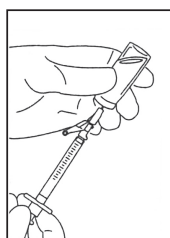

Figure 1

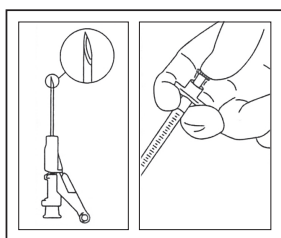

Figure 2

• Bevel Up = Lever Arm Up

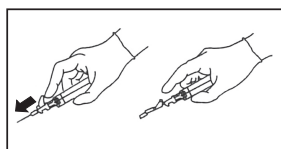

Figure 3

• Activated After Use

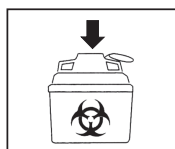

Figure 4

Push firmly when attaching the needle to the syringe.

Draw up medication in accordance with established protocol. (refer to Figure 1)

Administer medication in accordance with established protocols. For user convenience, the needle “bevel up” position is oriented to the lever arm as shown. (refer to Figure 2)

Activate Safety Mechanism immediately after removal from patient by pushing lever arm completely forward until needle tip is completely covered. Visually confirm that the lever arm has fully advanced and the needle tip is covered. If unable to activate, discard immediately into an approved sharps collector. (refer to Figure 3)

Discard after single use in an approved sharps collector in accordance with applicable regulations and institutional policy. (refer to Figure 4)

Use one handed technique and activate away from self and others.

Activation of the protective mechanism may cause minimal splatter of any fluid that is remaining on the needle after injection.

Non-pyrogenic. Do not use if individual packaging is damaged.

CAUTION:

Where local and/or institutional procedures permit/require transportation of the filled syringe, use a passive recapping technique to cover the needle before transporting to the point of administration. USA only: OSHA standards require that such recapping must be accomplished using a one handed technique. DO NOT hold the needle shield during the recapping process.

To help avoid HIV (AIDS), HBV (Hepatitis) and other infectious diseases due to accidental needlesticks, activate the protective mechanism immediately after use.

Federal (USA) law restricts this device to sale by or on the order of a physician.

Do not autoclave BD SafetyGlide™ Needle before use.

Caution: Re-use may lead to infection or other illness/injury.

K-01552-112B (5/15)